

Report to PLANNING & ORDERS COMMITTEE

Date 4/03/2015

Subject CYNGOR SIR YNYS MON/ISLE OF ANGLESEY COUNTY  
COUNCIL

(TRAFFIC REGULATION ORDER)(VARIOUS LOCATIONS  
LLANGEFNI)ORDER 2015

Portfolio Holder RICHARD DEW

Lead Officer HUW PERCY

Contact Officer ELFED LEWIS

Nature and reason for reporting

To report details of objections received following advertising the proposed  
Traffic Regulation Order.

#### A – INTRODUCTION/BACKGROUND/ISSUES

1.0 The proposed Order was prepared in response to representations received for parking restrictions in the interest of road safety and to address other traffic management issues in Llangefni. There was a collision on the B5111 Allt Saith Aelwyd in 2013 and complaints have been received about the parking. Following discussions with the North Wales Police and representatives of the Llangefni Town Council, Local Members (Canolbarth Mon) and Cwmni Tref Llangefni, it was agreed that it would be in the interest of road safety to prohibit parking on the last bay on the B5110 and to change the existing single yellow line to a double yellow line restriction.

A copy of the Notice of Proposal and plans detailing the proposed restrictions are attached (Enclosure 1).

1.1 In the initial consultation stage there were no objections to the proposed Order.

1.2 The Emergency Services have not objected to the proposal.

1.3 In the formal advertising stage three objections have been received with respect to the proposed Order (Copies attached). The objections are broadly based on the following grounds:-

- a) Loss of on-street parking for the residents of Church Terrace.
- b) Difficulty with parking of contractors vehicles undertaking any building renovation/improvement works including loading and unloading.
- c) Detrimental effect these changes would have on an established business operating in Church Terrace, and the implications for the business in terms of servicing their customers.

## 2.0 Current Situation

2.1 The objectors detailed in 1.3 are not satisfied that the provisions within the Order are acceptable.

2.2 The section of Church Terrace where the proposed No Waiting at any time restriction relates is already subjected to a Monday to Saturday 8am – 7pm parking restriction.

2.3 The existing Loading/Unloading arrangements on Church Terrace will be retained within the provisions of the proposed No Waiting at any time Order.

2.4 The parking bay on the B5110 near Coedlys is considered to be detrimental to road safety with frequent conflict at this location between oncoming vehicles. The removal of the parking bay will improve visibility, provide a refuge for vehicles that choose to proceed and facilitate the free movement of traffic along this section.

2.5 The Authority is considering the introduction of a residents parking scheme for Church Terrace and an initial feasibility consultation indicated local support for a scheme. This will be subjected to a separate consultation process in a subsequent Order.

2.6 The following Statutory Consultees have been consulted:-

- 1. North Wales Police
- 2. North Wales Fire and Rescue Service.

3. Locality Ambulance Officer.
4. The Road Haulage Association.
5. The Freight Transport Association.
6. Chief Engineer(Operational)
7. Local Members(CanolbarthMon)
8. Llangefni Town Council.

## B – CONSIDERATIONS

3.1 The proposed Order is considered essential in the interest of road safety and to facilitate the safe movement of traffic.

3.2 It will be for the Committee to determine if they feel the objections are justified or not.

## D – RECOMMENDATION

That if the Committee is satisfied that the objections are not significant and does not reflect the overall support, approves the proposal in accordance with the advertised Order and plans.

Name of author of report: Huw Percy

Job Title: Chief Engineer(Network)

Date 2015

Appendices

1. Notice of Proposal and Plans as Advertised
2. Copies of objections received at the advertising stage.

RHYBUDD O FWRIAD

NOTICE OF PROPOSAL

**GORCHYMYN CYNGOR SIR YNYS MÔN/ISLE OF ANGLESEY COUNTY COUNCIL (GORCHYMYN RHEOLI TRAFFIG) (AMRYW SAFLEOEDD LLANGFN) 2014**

**CYNGOR SIR YNYS MÔN/ISLE OF ANGLESEY COUNTY COUNCIL (TRAFFIC REGULATION ORDER) (VARIOUS LOCATIONS LLANGFN) ORDER 2014**

**RHODDIR RHYBUDD TRWY HYN** fod Cyngor Sir Ynys Môn/Isle of Anglesey County Council yn bwriadu gwneud Gorchymyn o dan Adran 1, 2, 4, 32 and 35 a rhan iv atodlen 9 o Ddeddf Rheoli Trafnidlaeth Fyrrd 1984.

**NOTICE IS HEREBY GIVEN** that Cyngor Sir Ynys Môn/Isle of Anglesey County Council proposes to make an Order under Sections 1, 2, 4, 32 and 35 and part iv of Schedule 9 of the Road Traffic Regulation Act 1984.

Pan ddaw'r Gorchymyn i rym ei effaith fydd darparu gwaharddriad a aros fel y celeir atynt yn Atodlen 1 yma a safle parclo i'r anabl fel y cyfeirir alo yn Atodlen 2 yma.

The effect of the Order will provide for the prohibition of waiting as referred to in Schedule 1 hereto and for a disabled parking bay as referred to in Schedule 2 hereto.

Mae'r Gorchymyn drafft, sydd ynghyd â chynllun yn dangos y ffordd yr effeithir aml a Datganiad o resymau'r Cyngor dros argymhell gwneud y Gorchymyn, ar gael i'w harchwilio gan y cyhoedd yn :-

The draft Order together with a map showing the length of road concerned and a Statement of the Council's reasons for proposing to make the Order may be examined at :-

- (a) Swyddfeydd y Cyngor, Llangedfni, rhwng 9.30 a.m. a 4.00 p.m. Llun i Gwener;
- (b) Y Llyfrgell Llangedfni yn ystod orlau gwaith arferol.

- (a) The Council Offices, Llangedfni, between the hours of 9.30 a.m. and 4.00 p.m. Monday to Friday.
- (b) The Llangedfni Library during normal business hours.

Os dymunwch wrthwynebu'r Gorchymyn arfaethedig anfonwch eich gwrthwynebiad mewn ysgrifen gan gynnwys eich rhesymau dros wneud hynny i'r Isod erbyn 22ain Ionawr, 2015.

If you wish to object to the proposed Order you should send your objection in writing specifying the ground thereof to the undersigned at the address specified by the 22<sup>nd</sup> January, 2015.

Bydd rhain ar gael i'w harchwilio gan y cyhoedd.

These will be available for public inspection.

**Atodlen**

**Schedule 1**

**B5110 LÔN CLAI**

Ar y ddwy ochr o bwynt 18 metr i'r gyffordd gyda Ffordd Maeshyryd i'r gyffordd gyda'r B5111 Lôn Las.

**B5110 LÔN CLAI**

On both sides from a point 18 metres north of its junction with Maeshyryd Road to its junction with the B5111 Church Terrace.

**B5111 LÔN LAS**

**Ochr ddwyreiniol**

- a) O'i chyffordd gyda'r B5110 Lôn Clai am bellter o 157 metr i gyfeiriad y gogledd.
- b) O'i chyffordd gyda'r B5110 Lôn Clai i'r gyffordd gyda Ffordd Cae Sel.

**B5111 CHURCH TERRACE**

**East Side**

- a) From its junction with the B5110 to Lôn Clai for a distance of 157 metres in a northerly direction.
- b) From its junction with the B5110 Lôn Clai to its junction with Ffordd Cae Sel

**Ochr orllewinol**

O bwynt 157 metr i'r gogledd o'r gyffordd gyda'r B5110 Lôn Clai am bellter o 212 metr i gyfeiriad y da.

**West side**

From a point 157 metres north of the junction with the B5110 for a distance of 212 metres in a southerly direction.

**A5114 FFORDD GLANHWFA**

**Ochr orllewinol**

O bwynt 50 metr i'r gogledd o'r gyffordd gyda Lôn Fron am bellter o 31 metr i gyfeiriad y gogledd.

**A5114 GLANHWFA ROAD**

**West side**

From a point 50 metres north of the junction with Fron Road for a distance of 31 metres in a northerly direction.

**B5109 STRYD FAWR**

**Ochr ddeheuol**

O bwynt 49 metr i'r gorllewin o'r gyffordd gyda Llawr y Dref am bellter o 12 metr i gyfeiriad y gorllewin.

**B5109 HIGH STREET**

**South side**

From a point 49 metres west of the junction with Llawr y Dref for a distance of 12 metres in a westerly direction.

**B5109 STRYD Y BONT**

**Ochr gogleddol**

O bwynt 24 metr i'r gorllewin o'r gyffordd gyda Lôn Newydd i'r gyffordd gyda Ger-y-Graig.

**B5109 BRIDGE STREET**

**North side**

From a point 24 metres west of the junction with Lôn Newydd to the junction with Ger-y-Graig.

**LÔN NEWYDD**

**Ochr gorllewinol**

O'r gyffordd gyda'r B5109 Stryd y Bont am bellter o 61 metr i gyfeiriad y gogledd.

**LÔN NEWYDD**

**West side**

From the junction with the B5109 Bridge Street for a distance of 61 metres in a northerly direction.

**Ochr ddwyreiniol**

O'r gyffordd gyda'r B5109 Stryd y Bont am bellter o 85 metr i gyfeiriad y gogledd.

**East side**

From the junction with the B5109 Bridge Street for a distance of 85 metres in a northerly direction.

**FFORDD GER-Y-GRAIG**

**Ochr gorllewinol**

O'r gyffordd gyda'r B5109 Stryd y Bont am bellter o 10 metr i gyfeiriad y gogledd.

**GER-Y-GRAIG ROAD, LLANGFN**

**West side**

From the junction with the B5109 Bridge Street for a distance of 10 metres in a northerly direction

**Schedule 2**

**Schedule 2**

**B5109 STRYD FAWR**

**Ochr ogleddol**

O bwynt 74 metr i'r gorllewin o'r gyffordd gyda Stryd y Cae am bellter o 8.6 metr i gyfeiriad y gorllewin.

**B5109 HIGH STREET**

**North side**

From a point 74 metres west of the junction with Field Street for a distance of 8.6 metres in a westerly direction.

Dyddiedig 04/12/2014

Dated

Arwyddwyd ym 04/12/2014  
 Signed  
 Robyn W Jones  
 Rheolwr Gwasanaethau Cyfreithiol / Legal Services Manager  
 Swyddfeydd y Cyngor / Council Offices  
 Llangedfni, Ynys Môn LL77 7TW

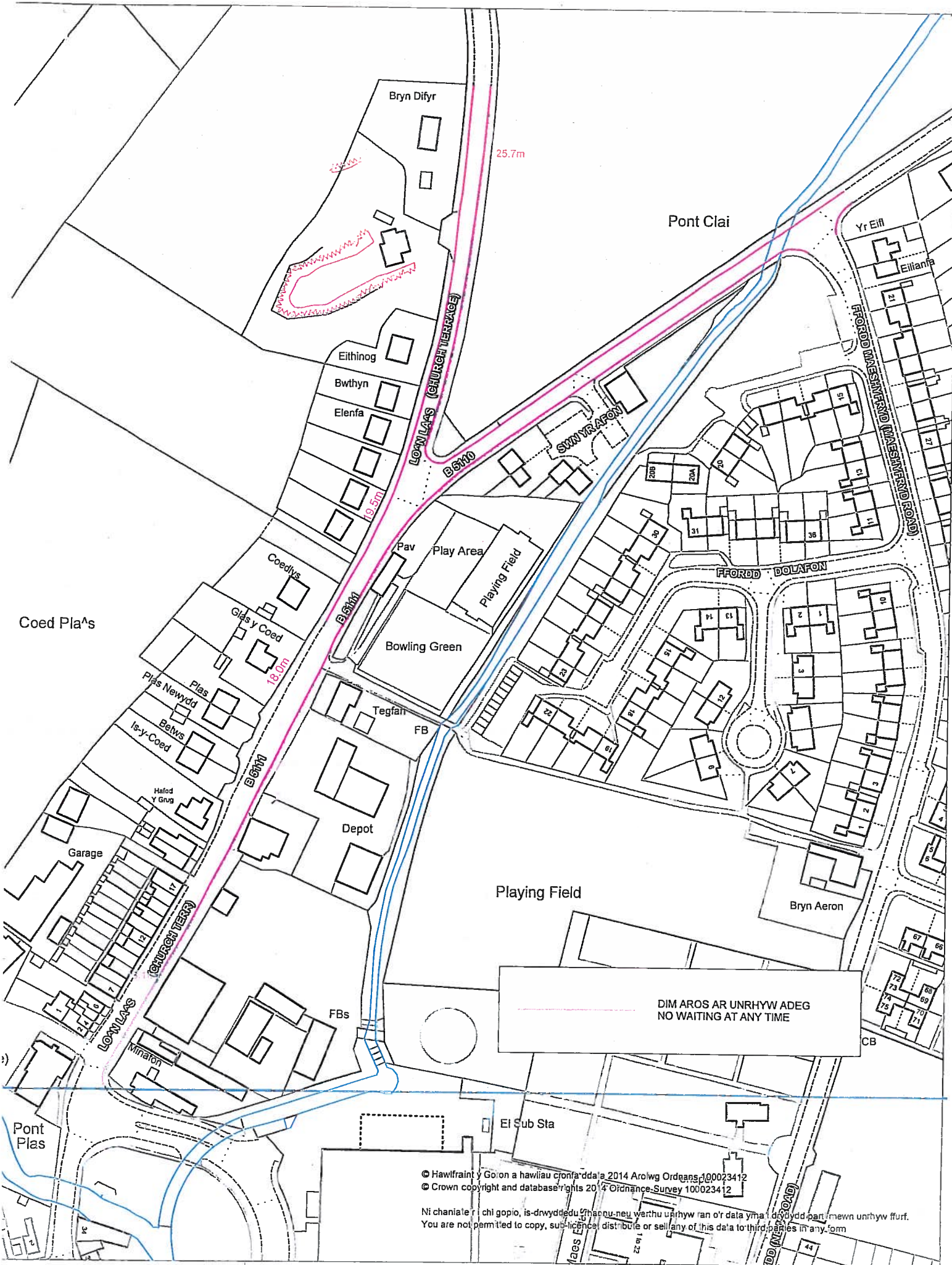

DIM AROS AR UNRHYW ADEG  
 NO WAITING AT ANY TIME

© Hawlfraint y Goon a hawliau cronfa'ddala 2014 Arolwg Ordnans 100023412  
 © Crown copyright and database rights 2014 Ordnance Survey 100023412

Ni chaniatir i chi gopïo, is-drwyddedu, rhannu neu werthu unrhyw ran o'r data yma i ddydd part mewn unrhyw ffurf.  
 You are not permitted to copy, sublicense, distribute or sell any of this data to third parties in any form.

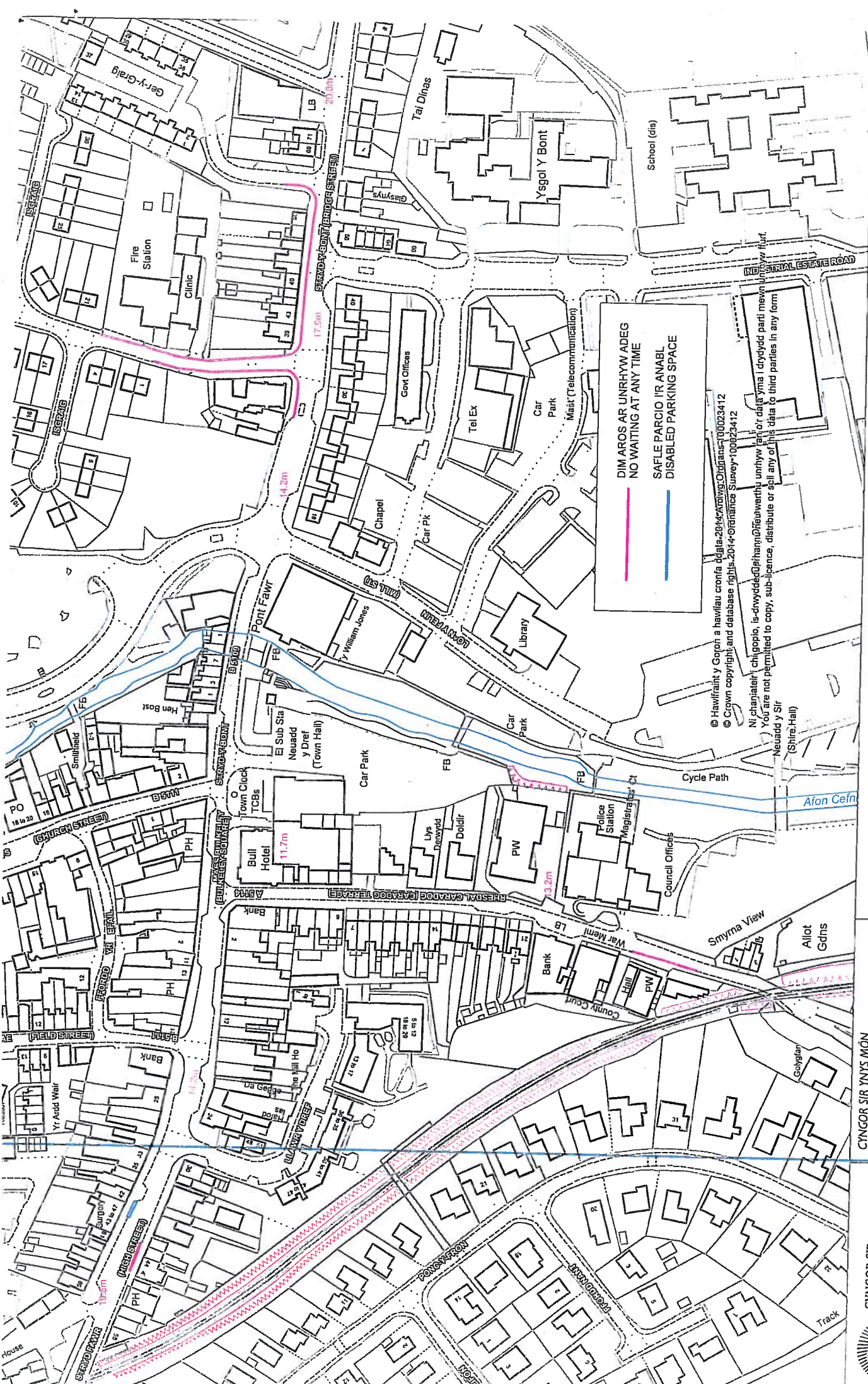

GORCHYMYN TRAFFIC ARFAETHEDIG/  
 PROPOSED TRAFFIC ORDER,  
 AMRYW LEOLIADAU/VARIOUS LOCATIONS,  
 LLANGENFI.

CYNGOR SIR YNYS MńN  
 ISLE OF ANGLESEY COUNTY COUNCIL  
 Swyddfa'r Sir  
 LLANGENFI  
 Ynys Môn - Anglesey  
 LL77 7TW

CYNGOR SIR  
 YNYS MńN  
 ISLE OF ANGLESEY  
 COUNTY COUNCIL



M019893.

3418

CYNGOR SIR YNYS MÔN  
ISLE OF ANGLESEY COUNTY COUNCIL

22 JAN 2015

REF: 0250034  
EZ Lon Las

Mr. Robyn Jones

Dear Sir,

The proposal to create a no parking policy is a bit inconvenient to many who live in Lon Las. There is hardly any where to park now - never mind if this goes ahead. No waiting is the death toll. I want friends to come & visit or give a helping hand. Where can they park? Maybe cameras to stop the fast drivers going towards B5111 would be more apt. If cars obey the mph/kph rule, there should be no need to create this traffic regulation order. One cannot park anywhere in this location. Residents should be able to & therefore a pass/permit should be issued. Do I have to get rid of my car & thus my freedom? This is not reasonable. Please amend your decision as it is not fair. Overtaking & reckless driving is the problem not parked cars. Thank you.

## Elfed Lewis

---

**From:** PEMHT  
**Sent:** 06 January 2015 10:26  
**To:** ger\_owen1@yahoo.co.uk  
**Cc:** Elfed Lewis  
**Subject:** PROPOSED TRAFFIC ORDER, CHURCH STREET, LLANGFNI REF HT-18083smj

**RE: PROPOSED TRAFFIC ORDER, CHURCH STREET, LLANGFNI**

025.00.34/M019163/EL/GW

Dear Mr

Thank you for your email of the 14<sup>th</sup> December, 2014 relating to the above mentioned proposal and I apologise for the delay in replying. Your comments relating to the proposed restrictions outside your premises are noted, and your email has been recorded as a formal objection to the proposed Order.

The Authority is required to pursue a lengthy consultation process with all Traffic Regulations Orders and consider the requirements of local businesses and residents. In the event of opposition to an Order at the advertising stage, all objections received are reported to the Planning and Orders Committee for their deliberation, and you will be notified on its decision in due course.

Yours faithfully

**A.R / P.P HUW PERCY  
PRIF BEIRIANNYDD (RHWYDWAITH) /  
CHIEF ENGINEER (NETWORK)**

A yw'r e-bost hwn wedi ei farcio'n 'Swyddogol-Sensitif'? Os ydyw, rhaid i chi ystyried a oes gennych hawl i'w ddyblygu, ei argraffu neu ai anfon ymlaen. Os oes, sicrhewch os gwelwch yn dda fod yr e-bost ynghyd ag unrhyw atodiadau'n cael eu marcio'n 'Swyddogol-Sensitif'. Eich cyfrifoldeb chi yw sicrhau fod mesurau'n cael eu cymryd i ddiogelu, storio a chael gwared ar y wybodaeth mewn modd priodol. Mae hyn yn golygu fod rhaid diogelu'r wybodaeth gyda chyfrinair neu ei chadw mewn cwpwrdd ffeilio y mae modd ei gloi. Rhaid cael gwared ar ddogfennau 'Swyddogol-Sensitif' yn y biniau gwastraff y mae modd eu cloi. Os ydych yn ansicr ynghylch sut i ddefnyddio gwybodaeth 'Swyddogol-Sensitif', yna cysylltwch os gwelwch yn dda gyda [cyfraithpolisi@ynysmon.gov.uk](mailto:cyfraithpolisi@ynysmon.gov.uk)

Has this e-mail been marked 'Official-Sensitive'? If so you must consider whether you have the right to duplicate, print or forward it on. If so please ensure that the e-mail and any attachments are marked as 'Official-Sensitive'. It is your responsibility to ensure that appropriate measures are taken to protect, store and dispose of this information properly. This means that the information must be password protected or kept in a lockable filing cabinet. 'Official-Sensitive' documents must be disposed of in the lockable waste bins. If you are unsure about how to use Official-Sensitive information please contact [legalpolicy@anglsey.gov.uk](mailto:legalpolicy@anglsey.gov.uk)



2505

GWYDDOGOL-SENSITIF/  
OFFICIAL-SENSITIVE

**Lynne H. Edwards**

**From:**  
**Sent:** 14 December 2014 21:33  
**To:** PEMHT  
**Subject:** REF: 18083 SMJ

ISLE OF ANGLESEY COUNTY COURT  
15 DEC 2014  
025.00.34.  
EL  
FFEI/FILE  
ATTIC  
P/...

Church Street  
LLANGFNI  
Ynys Mon  
LL77 7DU

Dear Sirs,

Ref: 18083 SMJ

We have looked carefully at the proposed new traffic order for outside our premises on Church Terrace, and we wish to strongly object to this order.

We have no doubt that these changes would have a detrimental effect on our business at \_\_\_\_\_, and could eventually lead to potential job losses if they are granted. Due to the location of our premises, these changes would have huge implications for our business in terms of servicing our customers.

There are currently no problems on this section to warrant these changes as the current system serves its purpose very well, and therefore we wish to suggest that these changes start from Siop Ellis onwards.

We would be grateful if you could confirm receipt of our objection.

Regards

A yw'r e-bost hwn wedi ei farcio'n 'Swyddogol-Sensitif'? Os ydyw, rhaid i chi ystyried a oes gennych hawl i'w ddyblygu, ei argraffu neu ai anfon ymlaen. Os oes, sicrhewch os gwelwch yn dda fod yr e-bost ynghyd ag unrhyw atodiadau'n cael eu marcio'n 'Swyddogol-Sensitif'. Eich cyfrifoldeb chi yw sicrhau fod mesurau'n cael eu cymryd i ddiogelu, storio a chael gwared ar y wybodaeth mewn modd priodol. Mae hyn yn golygu fod rhaid diogelu'r wybodaeth gyda chyfrinair neu ei chadw mewn cwpwrdd ffeilio y mae modd ei gloi. Rhaid cael gwared ar ddogfennau 'Swyddogol-Sensitif' yn y biniau gwastraff y mae modd eu cloi. Os ydych yn ansicr ynghylch sut i ddefnyddio gwybodaeth 'Swyddogol-Sensitif', yna cysylltwch os gwelwch yn dda gyda [cyfraithpolisi@ynysmon.gov.uk](mailto:cyfraithpolisi@ynysmon.gov.uk)

Has this e-mail been marked 'Official-Sensitive'? If so you must consider whether you have the right to duplicate, print or forward it on. If so please ensure that the e-mail and any attachments are marked as 'Official-Sensitive. It is your responsibility to ensure that appropriate measures are taken to protect, store and dispose of this information properly. This means that the information must be password protected or kept in a lockable filing cabinet. 'Official-Sensitive' documents must be disposed of in the lockable waste bins. If you are unsure about how to use Official-Sensitive information please contact [legalpolicy@anglesey.gov.uk](mailto:legalpolicy@anglesey.gov.uk)

~~2051~~  
2062.

**Glynwen Williams**

---

**From:** PEMHT  
**Sent:** 27 November 2014 12:00  
**To:**  
**Cc:** Alun Roberts  
**Subject:** Parking Church Terrace

ISLE OF ANGLESEY COUNTY COUNCIL

27 NOV 2014

(025.00.34 M018634)

Dear ,

I refer to your email dated 17<sup>th</sup> November 2014 concerning the above.

As detailed in a response to a previous email you submitted, objections to a proposed traffic regulation order may be submitted in writing to either –

[pem@anglesey.gov.uk](mailto:pem@anglesey.gov.uk)

or to

Legal Section, Isle of Anglesey County Council, Llangefni, Anglesey, LL77 7TW.

Your comments regarding the difficulties encountered by residents in parking along Church Terrace, Llangefni are acknowledged. It is intended to establish a residents parking scheme along Church Terrace and an initial feasibility consultation indicated local support for a scheme. In order to progress there is a need to prepare a draft traffic regulation order and advertise this on site and in the local press. The Authority is currently working through a backlog of drafting and advertising legal orders and therefore I am unable to provide a date as to when a proposed Church Terrace Residents Parking Scheme will be processed but I can assure you that it will be undertaken in due course.

Yours sincerely,

Alun Roberts  
Environment and Technical  
Isle of Anglesey County Council

2052

M018858

**Glynwen Williams**

**From:**  
**Sent:** 27 November 2014 11:33  
**To:** PEMHT  
**Subject:** FW: Parking Church Terrace

ALSO  
M18796

As it has been 10 days since I emailed you and I have not received any form of response, please find below my 2 messages from Monday 17th November 2014.

I hope someone is able to find the time to reply to me.

Regards

---

**From:**  
**To:** [highways@anglesey.gov.uk](mailto:highways@anglesey.gov.uk)  
**Subject:** FW: Parking Church Terrace  
**Date:** Mon, 17 Nov 2014 11:58:13 +0000

Further to my earlier message - having driven around looking for parking near my home for 45 minutes, I have had to pay to park in order to be able to come home and get on with my day. I am deeply unhappy about this situation and do not feel the council appreciates the difficulty the lack of resident parking arrangements is causing.

Regards

> **Subject:** Parking Church Terrace  
> **From:**  
> **Date:** Mon, 17 Nov 2014 11:00:31 +0000  
> **To:** [highways@anglesey.gov.uk](mailto:highways@anglesey.gov.uk)  
>

> To whom it may concern,

> Firstly I would like to complain about the complete lack of response to my recent email regarding the traffic regulation order notices on Church Terrace.

> Secondly, I would like to reiterate my objection to plans to further restrict and reduce parking in the area. As a resident of Church Terrace I have returned home this morning to find absolutely no parking in the vicinity of my property, and this is not the first time this has happened. Due to parking on the street being filled between the hours of 9am and 5pm I strongly suspect that people working in the town centre are parking here and preventing residents from parking. I do not believe that removing parking spaces on this road is in anyone's interests and that in fact further parking provisions should be made for residents.

> Regards

> Liz Shepherd

>

> Sent from my iPod

A yw'r e-bost hwn wedi ei farcio'n 'Swyddogol-Sensitif'? Os ydyw, rhaid i chi ystyried a oes gennych hawl i'w ddyblygu, ei argraffu neu ai anfon ymlaen. Os oes, sicrhewch os gwelwch yn dda fod yr e-bost ynghyd ag unrhyw atodiadau'n cael eu marcio'n 'Swyddogol-Sensitif'. Eich cyfrifoldeb chi yw sicrhau fod mesurau'n cael eu cymryd i ddiogelu, storio a chael gwared ar y wybodaeth mewn modd priodol. Mae hyn yn golygu fod rhaid diogelu'r wybodaeth gyda chyfrinair neu ei chadw mewn cwpwrdd ffeilio y mae modd ei gloi. Rhaid cael gwared ar ddogfennau

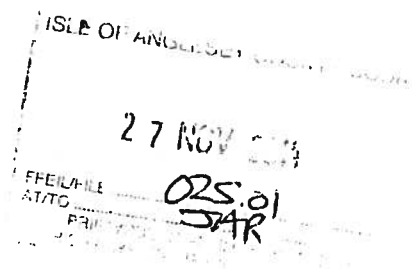

## **Elfed Lewis**

---

**From:** Huw M. Percy  
**Sent:** 10 November 2014 08:49  
**To:** Elfed Lewis  
**Subject:** FW: B5111 Parking - M018186 (025.00.34)

Er gwybodaeth

---

**From:**  
**Sent:** 08 November 2014 17:33  
**To:** Huw M. Percy  
**Subject:** RE: B5111 Parking - M018186 (025.00.34)

Dear Mr Percy,

Thank you for your response and explanation of the councils motivations for road alterations. It still appears rather unjust to me that one accident likely the result of bad driving and not the parking situation results in the loss of facilities and frustrating restrictions for local residents. A hasty driver is very likely to blame an accident on anything else in order to avoid their insurance claims. That being said it is understandable to put safety of road users first although I am still skeptical of the validation. I would request that parking provision for the bungalows on church terrace is not overlooked in future budgetary considerations. It is often difficult to find parking and once Rhiwlas sells there will be even more need for parking by the bungalows who are penalised most by the restrictions.

Having to apply for a dispensation will be very inconvenient, I would appreciate it if you could inform me of the process or contact details to organise this? I certainly hope such applications are not likely to be rejected due to restrictions to traffic flow.

It is clear that plans put in place will not be adjusted so it leaves me forced to look into creating a driveway to the front of the house, a large expense and huge inconvenience. I hope you understand my frustration in having to make such adjustments to remedy further restrictions which I feel will only benefit those who already drive inappropriately on the roads in front of the house.

While I am not happy about the proposed changes I am grateful for your detailed response.

Yours sincerely

---

**From:** [HuwPercy@anglesey.gov.uk](mailto:HuwPercy@anglesey.gov.uk)  
**To:**  
**CC:** [PEMHT@anglesey.gov.uk](mailto:PEMHT@anglesey.gov.uk)  
**Subject:** B5111 Parking - M018186 (025.00.34)  
**Date:** Fri, 7 Nov 2014 14:02:57 +0000

Dear

Opposition to Proposed traffic Order, B5110 and B5111 Lon Las/Church Terrace, Llangefni.

Thank you for your email of the 30<sup>th</sup> October, 2014 relating to the above mentioned proposal. Your comments relating to the proposed restrictions opposite Bwthyn, Church Terrace, Llangefni are noted.

I shall respond to your comments as follows:-

There was a collision on the B5111 Allt Saith Aelwyd in 2013 and complaints were received about the parking. The matter was discussed with North Wales Police and a group consisting of Council Officers, Llangefni Town Council, County Councillors and Cwmni Tref Llangefni. It was agreed that it would be in the interests of road safety to prohibit parking on the last bay on the B5110 and to change the single yellow line to a double yellow line restriction.

Any existing loading and unloading arrangements on the current restrictions will be retained if a double yellow line parking prohibition is introduced. Contractors who require parking for their vehicles close to a property may also apply for a dispensation which allows a specific vehicle to park in a restricted area while work is being carried out.

The parking bay near Coedlys and the entrance to the Dingle footpath is considered to be detrimental to road safety with frequent conflict at this location between oncoming vehicles. The removal of the bay referred to will improve visibility, provide a refuge for vehicles that choose to proceed and facilitate the free movement of traffic along this section.

I note your comment on additional parking provision for residents but I regret that there is currently no funding available for such works. The areas you propose however are not considered suitable for the provision of additional parking places.

The Authority is required to pursue a lengthy consultation process with all Traffic Regulation Orders and consider the requirements of local residents. Road safety and the safe movement of traffic will however will be an over-riding consideration with any Traffic Regulation Order.

In the event of opposition to an Order at the advertising stage, all objections received are reported to the Planning and Orders Committee for their deliberation. Your email has been recorded as a formal objection to the proposed Order. Should there be any indication at this stage that local residents are not fully aware of the proposals for any reason the proposal will be re-advertised and individual properties notified directly.

I trust that this clarifies the situation regarding the current proposal.

*Huw*

**Huw Percy,**

Prif Beiriannydd/Chief Engineer.

[Dilynwch ni ar Twitter](#) / [Darganfyddwch ni ar Facebook](#)

[Follow us on Twitter](#) / [Find us on Facebook](#)

This email and any files transmitted with it are confidential and may be legally privileged. They may be read copied and used only by the intended recipient. If you have received this email in error please immediately notify the system manager using the details below, and do not disclose or copy its contents to any other person.

The contents of this email represent the views of the sender only and do not necessarily represent the views of Isle of Anglesey County Council. Isle of Anglesey County Council reserves the right to monitor all email communications through its internal and external networks.

Mae'r neges e-bost hon a'r ffeiliau a drosglwyddyd ynghlwm gyda hi yn gyfrinachol ac efallai bod breintiau

## Glynwen Williams

---

**From:** PEMHT  
**Sent:** 07 November 2014 14:26  
**To:**  
**Cc:** Elfed Lewis  
**Subject:** Traffic Regulation Order

M018299/025.00.34

Dear

### Traffic Regulation Order

Thank you for your email of the 5<sup>th</sup> November, 2014 relating to the above mentioned.

Objections to a proposed traffic Order can be submitted by email or by letter to the following address:-

- a) Email to [pem@anglesey.gov.uk](mailto:pem@anglesey.gov.uk)
- b) Isle of Anglesey County Council, Managing Director's Department, Legal Section, Council Office, Llangefni, Anglesey, LL77 7TW

Yours faithfully

**A.R / P.P HUW PERCY  
PRIF BEIRIANNYDD (RHWYDWAITH) /  
CHIEF ENGINEER (NETWORK)**

1302

SWYDDOGOL-SENSITIF/  
OFFICIAL-SENSITIVE

Sian W Davies

**From:**  
**Sent:** 05 November 2014 11:44  
**To:** PEMHT  
**Subject:** Traffic Regulation Order

M 018299

To whom it may concern,

Could you please inform me how I can go about lodging an objection/comment on a current Traffic Regulation Order?

Many Thanks

A yw'r e-bost hwn wedi ei farcio'n 'Swyddogol-Sensitif'? Os ydyw, rhaid i chi ystyried a oes gennych hawl i'w ddyblygu, ei argraffu neu ai anfon ymlaen. Os oes, sicrhewch os gwelwch yn dda fod yr e-bost ynghyd ag unrhyw atodiadau'n cael eu marcio'n 'Swyddogol-Sensitif'. Eich cyfrifoldeb chi yw sicrhau fod mesurau'n cael eu cymryd i ddiogelu, storio a chael gwared ar y wybodaeth mewn modd priodol. Mae hyn yn golygu fod rhaid diogelu'r wybodaeth gyda chyfrinair neu ei chadw mewn cwpwrdd ffeilio y mae modd ei gloi. Rhaid cael gwared ar ddogfennau 'Swyddogol-Sensitif' yn y biniau gwastraff y mae modd eu cloi. Os ydych yn ansicr ynghylch sut i ddefnyddio gwybodaeth 'Swyddogol-Sensitif', yna cysylltwch os gwelwch yn dda gyda [cyfraithpolisi@ynysmon.gov.uk](mailto:cyfraithpolisi@ynysmon.gov.uk)

Has this e-mail been marked 'Official-Sensitive'? If so you must consider whether you have the right to duplicate, print or forward it on. If so please ensure that the e-mail and any attachments are marked as 'Official-Sensitive'. It is your responsibility to ensure that appropriate measures are taken to protect, store and dispose of this information properly. This means that the information must be password protected or kept in a lockable filing cabinet. 'Official-Sensitive' documents must be disposed of in the lockable waste bins. If you are unsure about how to use Official-Sensitive information please contact [legalpolicy@anglesey.gov.uk](mailto:legalpolicy@anglesey.gov.uk)

ISLE OF ANGLESEY COUNTY COUNCIL

- 5 NOV 2014

FFEIL/FILE... *025.00.34*  
AT/TO...  
PRIFYRDD, TRAFNIDIAETH AC EIDDO  
HIGHWAYS TRANSPORT AND PROPERTY

928

**Carolyn A. Jones**

---

**From:** Carolyn A. Jones  
**Sent:** 23 October 2014 13:43  
**To:** PEMHT  
**Subject:** FW: Traffic Regulation Order - Church Terrace

---

**From:** PEMHT  
**Sent:** 23 October 2014 13:37  
**To:**  
**Cc:** Elfed Lewis  
**Subject:** RE: Traffic Regulation Order - Church Terrace

025.00.34 m018019

Dear

**Proposed Traffic Regulation Order – Church Terrace**

Thank you for your e-mail of the 23<sup>rd</sup> October, 2014 relating to the above mentioned.

If you could arrange to contact my assistant Mr. E. Lewis Tel. 01248 752374 directly, he would be happy to meet you on site to discuss the proposed traffic Order as advertised.

---

**From:**  
**Sent:** 23 October 2014 08:28  
**To:** PEMHT  
**Subject:** Traffic Regulation Order - Church Terrace

To whom it may concern,

I recently noticed a Traffic Regulation Order tapped to a sign post near where I park my car on Church Terrace in Llangefni. I did read the notice but to be honest I couldn't really understand what it was saying. Would it be possible for someone to give me a simpler explanation of the changes to waiting (parking?) that will be taking place in the area and if this will affect the designated parking bays on Church Terrace in the stretch of road opposite Siop Ellis?

Diolch yn fawr

A yw'r e-bost hwn wedi ei farcio'n 'Swyddogol-Sensitif'? Os ydyw, rhaid i chi ystyried a oes gennych hawl i'w ddyblygu, ei argraffu neu ai anfon ymlaen. Os oes, sicrhewch os gwelwch yn dda fod yr e-bost ynghyd ag unrhyw atodiadau'n cael eu marcio'n 'Swyddogol-Sensitif'. Eich cyfrifoldeb chi yw sicrhau fod mesurau'n cael eu cymryd i ddiogelu, storio a chael gwared ar y wybodaeth mewn modd priodol. Mae hyn yn golygu fod rhaid diogelu'r wybodaeth gyda chyfrinair neu ei chadw mewn cwpwrdd ffeilio y mae modd ei gloi. Rhaid cael gwared ar ddogfennau 'Swyddogol-Sensitif' yn y biniau gwastraff y mae modd eu cloi. Os ydych yn ansicr ynghylch sut i ddefnyddio gwybodaeth 'Swyddogol-Sensitif', yna cysylltwch os gwelwch yn dda gyda [cyfraithpolisi@vnysmon.gov.uk](mailto:cyfraithpolisi@vnysmon.gov.uk)

Has this e-mail been marked 'Official-Sensitive'? If so you must consider whether you have the



## Elfed Lewis

---

**From:** Huw M. Percy  
**Sent:** 07 November 2014 14:03  
**To:** Elfed Lewis  
**Subject:** FW: B5111 Parking - M018186 (025.00.34)

Er gwybodaeth

---

**From:** Huw M. Percy  
**Sent:** 07 November 2014 14:03  
**To:**  
**Cc:** [pem@ynysmon.gov.uk](mailto:pem@ynysmon.gov.uk)  
**Subject:** B5111 Parking - M018186 (025.00.34)

Dear

Opposition to Proposed traffic Order, B5110 and B5111 Lon Las/Church Terrace, Llangefni.

Thank you for your email of the 30<sup>th</sup> October, 2014 relating to the above mentioned proposal. Your comments relating to the proposed restrictions opposite Bwthyn, Church Terrace, Llangefni are noted.

I shall respond to your comments as follows:-

There was a collision on the B5111 Allt Saith Aelwyd in 2013 and complaints were received about the parking. The matter was discussed with North Wales Police and a group consisting of Council Officers, Llangefni Town Council, County Councillors and Cwmni Tref Llangefni. It was agreed that it would be in the interests of road safety to prohibit parking on the last bay on the B5110 and to change the single yellow line to a double yellow line restriction.

Any existing loading and unloading arrangements on the current restrictions will be retained if a double yellow line parking prohibition is introduced. Contractors who require parking for their vehicles close to a property may also apply for a dispensation which allows a specific vehicle to park in a restricted area while work is being carried out.

The parking bay near Coedlys and the entrance to the Dingle footpath is considered to be detrimental to road safety with frequent conflict at this location between oncoming vehicles. The removal of the bay referred to will improve visibility, provide a refuge for vehicles that choose to proceed and facilitate the free movement of traffic along this section.

I note your comment on additional parking provision for residents but I regret that there is currently no funding available for such works. The areas you propose however are not considered suitable for the provision of additional parking places.

The Authority is required to pursue a lengthy consultation process with all Traffic Regulation Orders and consider the requirements of local residents. Road safety and the safe movement of traffic will however will be an over-riding consideration with any Traffic Regulation Order.

In the event of opposition to an Order at the advertising stage, all objections received are reported to the Planning and Orders Committee for their deliberation. Your email has been recorded as a formal objection to the proposed Order. Should there be any indication at this stage that local residents are not fully aware

of the proposals for any reason the proposal will be re-advertised and individual properties notified directly.

I trust that this clarifies the situation regarding the current proposal.

*Huw*

**Huw Percy,**

Prif Beiriannydd/Chief Engineer.

A yw'r e-bost hwn wedi ei farcio'n 'Swyddogol-Sensitif'? Os ydyw, rhaid i chi ystyried a oes gennych hawl i'w ddyblygu, ei argraffu neu ai anfon ymlaen. Os oes, sicrhewch os gwelwch yn dda fod yr e-bost ynghyd ag unrhyw atodiadau'n cael eu marcio'n 'Swyddogol-Sensitif'. Eich cyfrifoldeb chi yw sicrhau fod mesurau'n cael eu cymryd i ddiogelu, storio a chael gwared ar y wybodaeth mewn modd priodol. Mae hyn yn golygu fod rhaid diogelu'r wybodaeth gyda chyfrinair neu ei chadw mewn cwpwrdd ffeilio y mae modd ei gloi. Rhaid cael gwared ar ddogfennau 'Swyddogol-Sensitif' yn y biniau gwastraff y mae modd eu cloi. Os ydych yn ansicr ynghylch sut i ddefnyddio gwybodaeth 'Swyddogol-Sensitif', yna cysylltwch os gwelwch yn dda gyda [cyfraithpolisi@ynysmon.gov.uk](mailto:cyfraithpolisi@ynysmon.gov.uk)

Has this e-mail been marked 'Official-Sensitive'? If so you must consider whether you have the right to duplicate, print or forward it on. If so please ensure that the e-mail and any attachments are marked as 'Official-Sensitive'. It is your responsibility to ensure that appropriate measures are taken to protect, store and dispose of this information properly. This means that the information must be password protected or kept in a lockable filing cabinet. 'Official-Sensitive' documents must be disposed of in the lockable waste bins. If you are unsure about how to use Official-Sensitive information please contact [legalpolicy@anglesey.gov.uk](mailto:legalpolicy@anglesey.gov.uk)

1140

M 018186

**Lynne H. Edwards**

---

**From:**  
**Sent:** 30 October 2014 10:39  
**To:** PEMHT  
**Subject:** re: Opposition to Proposed traffic order, B5110 A B5111 LON LAS/ CHURCH TERRACE, LLANGFN1

30 OCT 2014

025.00.34  
EL

Dear whom it may concern,

I would like to comment on the proposed traffic order, B5110 A B5111 LON LAS/ CHURCH TERRACE, LLANGFN1. As a local resident who will be greatly affected by the change to road markings and parking bay removal I would like to make my opposition to the proposed traffic order known. I imagine me and my partner ( ) may well be the only local residents who have noticed the signs and who have bothered to contact you, so I hope you will listen to our concerns.

I view the proposed traffic order as an absolute needless endeavour and a waste of tax payers money. Next to nobody parks on the single yellow lines during the permitted hours so changing them to double yellow lines will change nothing. The roads are also quiet during these permitted hours so I see no reason for change. While it is a very rare occasion somebody will park on the single yellow lines, having the flexibility for workmen to park outside my property of an evening or sunday is incredibly useful and not something I would like to see removed. We are in the process of renovation works and altering parking restrictions will make further progress on the house difficult not to mention reducing the value of the property. We were almost put off from buying it in the first place because of the single yellow lines and double yellow lines will clearly put off potential buyers for the bungalow that is still for sale. If parking restrictions are applied to be constantly in force then how on earth is anybody along church terrace ever supposed to have any building work carried out on their houses? Workmen who need to constantly go back and forth to their vehicles can hardly waste time walking all the way down the street every time they need something. This is of course if they can find parking on the more southerly part of church terrace at all. This problem created by the proposed changes could add considerable expense and inconvenience to any residents who live in the row of bungalows.

The removal of two parking spaces with the proposed plans are going to make it even more difficult to park anywhere remotely near my house (Bwthyn). This end bay is also very convenient and causes less traffic build up than having to parallel park my larger vehicle into the bays which will remain with the proposed plans. I see no reason why the parking bays near Coedlys and the entrance to the dingle need be removed. They are far from the junction and do not cause any obstruction. If anything cars parked in this bay serve as a good protection to those pedestrians often with dogs or push chairs who walk on the narrow path by the entrance to the dingle. Not to mention helping to slow down cars which ignore the 30 mile per hour speed limit and rip up the more northerly part of church terrace at ridiculous speeds. Removing this last parking space will only give them more time to accelerate and encourage such behaviour.

If the council insists of constantly persecuting residents who live in the bungalows to allow for the bad driving of those passing through by enforcing further parking restrictions then something needs to be done to mitigate our parking situation. The footpath on the eastern side of church terrace (northerly part near the bungalows) next to the pastoral field is very wide. There is no need to have a footpath on both sides of this road as it is very rarely traversed and most people use the side of the path near the houses. This footpath could easily be converted into several parking bays to provide for the bungalows who currently have no parking access anywhere near their houses. There is also a small plot of waste land where people used to park opposite Elenfa which could easily be converting into 3 parking bays. Such pursuits would be a useful spend of

tax payers money to actually provide a service to residents instead of wasting money on needless endeavours that only make things more problematic.

I really hope that this proposal will be given more consideration and the problems to local residents considered more in future plans and developments.

Yours sincerely

Bwthyn, Church Terrace, Llangefni, Anglesey, LL777EB

A yw'r e-bost hwn wedi ei farcio'n 'Swyddogol-Sensitif'? Os ydyw, rhaid i chi ystyried a oes gennych hawl i'w ddyblygu, ei argraffu neu ai anfon ymlaen. Os oes, sicrhewch os gwelwch yn dda fod yr e-bost ynghyd ag unrhyw atodiadau'n cael eu marcio'n 'Swyddogol-Sensitif'. Eich cyfrifoldeb chi yw sicrhau fod mesurau'n cael eu cymryd i ddiogelu, storio a chael gwared ar y wybodaeth mewn modd priodol. Mae hyn yn golygu fod rhaid diogelu'r wybodaeth gyda chyfrinair neu ei chadw mewn cwpwrdd ffeilio y mae modd ei gloi. Rhaid cael gwared ar ddogfennau 'Swyddogol-Sensitif' yn y biniau gwastraff y mae modd eu cloi. Os ydych yn ansicr ynghylch sut i ddefnyddio gwybodaeth 'Swyddogol-Sensitif', yna cysylltwch os gwelwch yn dda gyda [cyfraithpolisi@vnysmon.gov.uk](mailto:cyfraithpolisi@vnysmon.gov.uk)

Has this e-mail been marked 'Official-Sensitive'? If so you must consider whether you have the right to duplicate, print or forward it on. If so please ensure that the e-mail and any attachments are marked as 'Official-Sensitive'. It is your responsibility to ensure that appropriate measures are taken to protect, store and dispose of this information properly. This means that the information must be password protected or kept in a lockable filing cabinet. 'Official-Sensitive' documents must be disposed of in the lockable waste bins. If you are unsure about how to use Official-Sensitive information please contact [legalpolicy@anglesey.gov.uk](mailto:legalpolicy@anglesey.gov.uk)

928

**Carolyn A. Jones**

---

**From:** Carolyn A. Jones  
**Sent:** 23 October 2014 13:43  
**To:** PEMHT  
**Subject:** FW: Traffic Regulation Order - Church Terrace

---

**From:** PEMHT  
**Sent:** 23 October 2014 13:37  
**To:** 'Liz S'  
**Cc:** Elfed Lewis  
**Subject:** RE: Traffic Regulation Order - Church Terrace

025.00.34 m018019

Dear

**Proposed Traffic Regulation Order – Church Terrace**

Thank you for your e-mail of the 23<sup>rd</sup> October, 2014 relating to the above mentioned.

If you could arrange to contact my assistant Mr. E. Lewis Tel. 01248 752374 directly, he would be happy to meet you on site to discuss the proposed traffic Order as advertised.

---

**From:**  
**Sent:** 23 October 2014 08:28  
**To:** PEMHT  
**Subject:** Traffic Regulation Order - Church Terrace

To whom it may concern,

I recently noticed a Traffic Regulation Order tapped to a sign post near where I park my car on Church Terrace in Llangefni. I did read the notice but to be honest I couldn't really understand what it was saying. Would it be possible for someone to give me a simpler explanation of the changes to waiting (parking?) that will be taking place in the area and if this will affect the designated parking bays on Church Terrace in the stretch of road opposite Siop Ellis?

Diolch yn fawr

A yw'r e-bost hwn wedi ei farcio'n 'Swyddogol-Sensitif'? Os ydyw, rhaid i chi ystyried a oes gennych hawl i'w ddyblygu, ei argraffu neu ai anfon ymlaen. Os oes, sicrhewch os gwelwch yn dda fod yr e-bost ynghyd ag unrhyw atodiadau'n cael eu marcio'n 'Swyddogol-Sensitif'. Eich cyfrifoldeb chi yw sicrhau fod mesurau'n cael eu cymryd i ddiogelu, storio a chael gwared ar y wybodaeth mewn modd priodol. Mae hyn yn golygu fod rhaid diogelu'r wybodaeth gyda chyfrinair neu ei chadw mewn cwpwrdd ffellio y mae modd ei gloi. Rhaid cael gwared ar ddogfennau 'Swyddogol-Sensitif' yn y biniau gwastraff y mae modd eu cloi. Os ydych yn ansicr ynghylch sut i ddefnyddio gwybodaeth 'Swyddogol-Sensitif', yna cysylltwch os gwelwch yn dda gyda [cyfraithpolisi@ynysmon.gov.uk](mailto:cyfraithpolisi@ynysmon.gov.uk)

Has this e-mail been marked 'Official-Sensitive'? If so you must consider whether you have the